

Kfz. 305 Opel Blitz Typ A 4x4



**NEW
MOULDS**

1:35
scalascale



Figure not included

No 6760 model kit
modèle réduit

Model Kit features

The Opel Blitz medium truck formed the backbone of the logistics and transport system of the German Army during the Second World War.

Produced in significant numbers, it was characterized by its flexibility and robustness in service, enhanced by the rear axle combined with twin wheels, which ensured greater payload capacity under all operating conditions. Designed to be easy to manufacture, repair, and maintain, it was effectively employed by the Wehrmacht on all major operational fronts, from North Africa to Russia, demonstrating the soundness of its design. It was produced in numerous configurations and versions, including the effective 4x4 variant capable of ensuring good performance even on difficult terrain.

**New moulds
Rubber tyres**

Decals sheet for 4 versions 



17.1 cm

moulds shot test



Moulds

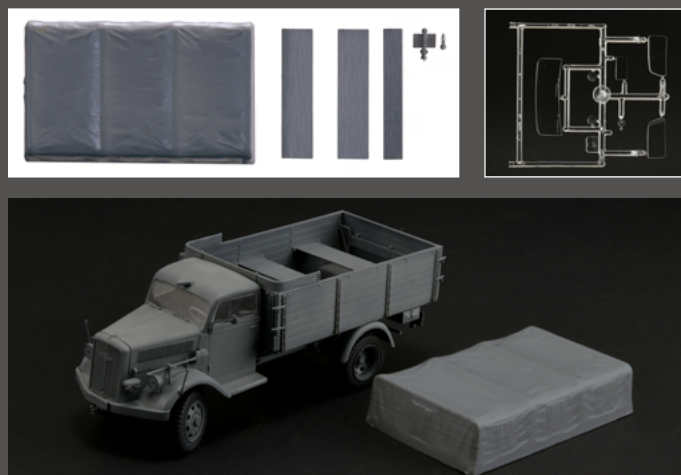
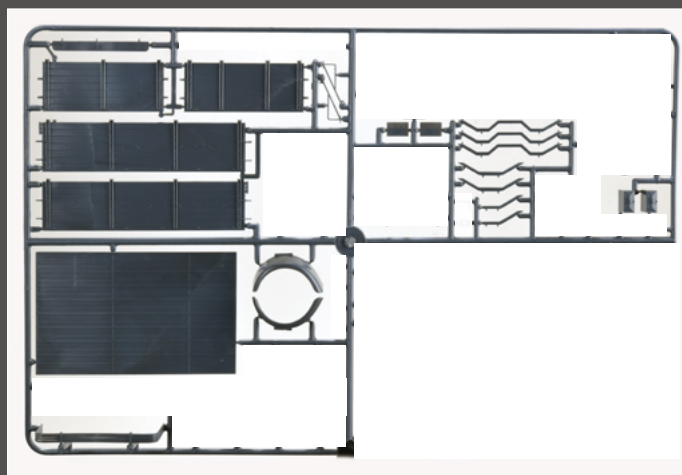
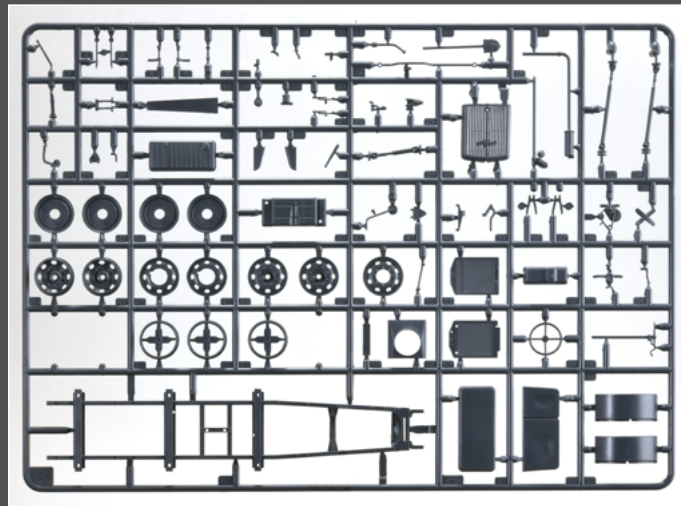
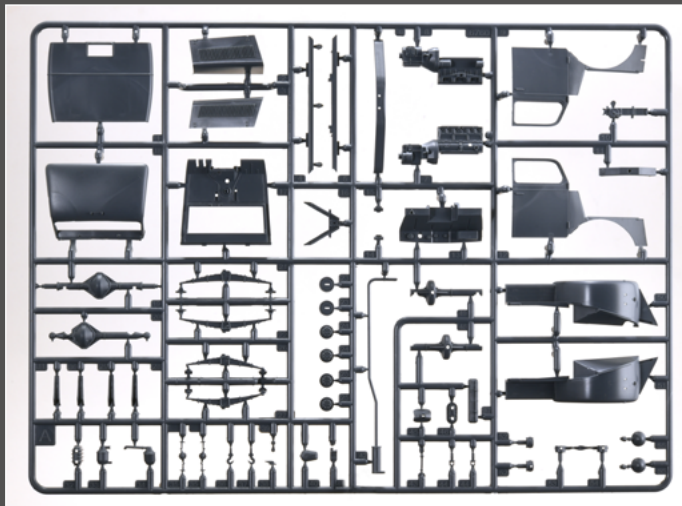

moulds shot test

Decals versions

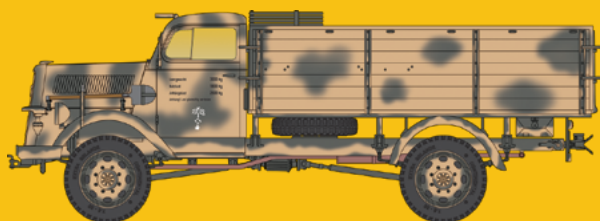

A. Wehrmacht, D.A.K., 21th Panzer Division, Libya, summer 1942.



B. Wehrmacht, Pz. Div. "Grossdeutschland", eastern front, spring 1943.



C. Wehrmacht, 2nd Pz. Div., Artillerie-Regiment 74, Normandy, June 1944.

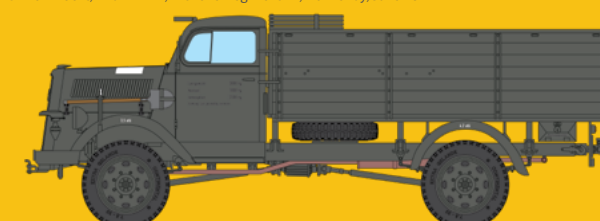

D. Wehrmacht, D.A.K., unknown unit, Libya, 1941.

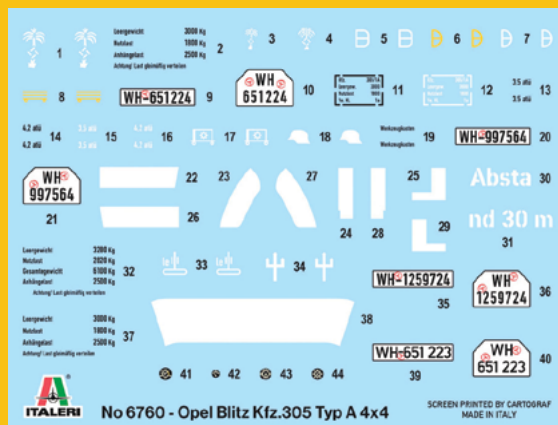

Decals sheet

